

Linx

Continuous Ink Jet Printers

Parts List

Linx Continuous Ink Jet Printers Parts List



Using This Parts and Prices List

The information in this Parts List is to provide a distributor of Linx products with sufficient information to identify and order spare parts for the Linx range of Continuous Ink Jet Printers. Products and component parts described in this document are subject to continuous development, and reviews will be made periodically in further issues and amendments.

To assist in identifying the relevant part number, numbered illustrations are provided where possible.

Disclaimer and Copyright

Information of a technical nature and particulars of the spare parts and their use are given by Linx in good faith.

At all times, Linx Continuous Ink Jet Printers must be operated with Linx-approved spares. Linx cannot accept liability for any loss or damage caused by the fitting or use of unauthorized spare parts.

The Parts List is intended to assist the distributor to maintain Linx products, and every care has been taken to be precise and accurate. However, Linx shall not be liable for any loss or damage arising from the use of any information herein, errors or omissions, or any incorrect use of the spare parts and products whatsoever.

Neither whole nor part of the information contained in this manual, nor the products described, may be adapted or reproduced in any material form without prior written consent of Linx Printing Technologies Ltd.

This Edition published 11 June 2013
© 2013 Linx Printing Technologies Ltd

LINX is a registered trademark of Linx Printing Technologies Ltd.
Unauthorized use of the LINX trademark is strictly forbidden.

In addition to our standard terms and conditions, you should note the following:

- 1.
- 2.
3.

Ex-stock:	Items will be available for despatch within 3 working days of receipt of order.
X Weeks:	Items will be available for despatch within X weeks of receipt of order.
Enquire:	Please contact Linx Sales office for advice on availability terms.
Last Stock:	Stocks of these spare parts are limited; supply is subject to availability.

Orders for large quantities of single items may be subject to scheduled deliveries. If this happens, the first part delivery of any order will be despatched according to the terms defined above.

Linx Continuous Ink Jet Printers
Section 16 - Accessories - Cabinets and Washdown Printhead Stands



Item	Part Num	Description	Qty	Availability	Comments
1	FA62569	SELF-ASSEMBLY PRINTER CABINET	1	EX-STOCK	Replaces FA62033 - Printer Cabinet.
2	FA74126	REPLACEMENT CABINET WHEELS - PACK	4	EX-STOCK	
3	FA74122	REPLACEMENT CABINET LOCK ASSEMBLY	1	EX-STOCK	
4	FA62034	PRINTER MOUNTING TABLE	1	EX-STOCK	To accommodate one or two printers. Not suitable for bolt-on gantries.

Linx Continuous Ink Jet Printers

Section 16 - Accessories - Cabinets and Washdown Printhead Stands



Item	Part Num	Description	Qty	Availability	Comments
5	FA62070	PRINthead MOUNTING ASSY - FLOOR MOUNT FIXED	1	EX-STOCK	
6	FA62041	PRINthead MOUNTING ASSY FLOOR MOUNT	1	EX-STOCK	Contains 32 mm diameter poles & adjustable printhead mount.
7	FA62043	PRINthead MOUNTING ASSY DIRECT HORIZONTAL MOUNT	1	EX-STOCK	Contains 32 mm diameter poles & adjustable printhead mount.
8	FA62042	PRINthead MOUNTING ASSY DIRECT VERTICAL MOUNT	1	EX-STOCK	When attached to FA62569 Printer Cabinet two spacers FA62061 must be used.
	FA62061	SPACER - PRINTER CABINET	1	EX-STOCK	See PB0608 .
	FA74129	PRINthead SPLASH COVER - PACK	20	EX-STOCK	To protect printheads against water ingress during wash down.
	FA61097	6000 INTERNAL ALARM CABLEFORM	1	EX-STOCK	Internal Cableform for 24 V alarm output. For 6000 & 6200 printers.

Linx Continuous Ink Jet Printers
Section 16 - Accessories - Washdown Mounting Accessories (32 mm Diameter Poles)



Item	Part Num	Description	Qty	Availability	Comments
1	FA62046	PRINthead BRACKET, FIXED - POLE MOUNT	1	EX-STOCK	Complete with Index Sleeve to provide repeatable location of printhead.
2	FA67056	ADJUSTABLE PRINthead BRACKET HANDSCREW ASSY	1	EX-STOCK	
3	FA62047	PRINthead BRACKET, ADJUSTABLE - POLE MOUNT	1	EX-STOCK	Complete with Index Sleeve to provide repeatable location of printhead.
4	FA62066	PRINthead BRACKET HANDSCREW POLE MOUNT	1	EX-STOCK	

Linx Continuous Ink Jet Printers

Section 16 - Accessories - Washdown Mounting Accessories (32 mm Diameter Poles)



Item	Part Num	Description	Qty	Availability	Comments
5	FA62057	PRINthead COVER TUBE/INDEX SLEEVE ASSEMBLY	1	EX-STOCK	To enable printhead cover tube to fit printhead mounts FA62044,FA62046 & FA62047.
6	FA62044	PRINthead BRACKET, FIXED - DIRECT MOUNT	1	EX-STOCK	Complete with Index Sleeve to provide repeatable location of printhead.
7	FA62049	BASE - DIRECT/VERTICAL MOUNT, FIXED	1	EX-STOCK	
8	FA62050	BASE - DIRECT HORIZONTAL MOUNT, FIXED	1	EX-STOCK	
	FA62061	SPACER - PRINTER CABINET	1	EX-STOCK	See PB0608 .
9	FA62051	BASE - FLOOR MOUNT, FIXED	1	EX-STOCK	
10	FA62052	BASE - FLOOR MOUNT, MOBILE	1	EX-STOCK	
11	FA62048	CROSS JOINT	1	EX-STOCK	To join a 32 mm diameter cross pole to a vertical pole.
12	FA67055	CROSS JOINT HANDSCREW ASSEMBLY	1	EX-STOCK	Replaces the hex-key-adjusted cross clamp in the cross joint.
13	FA62065	HANDSCREW ADJUSTABLE CROSS JOINT	1	EX-STOCK	
14	FA62062	CROSS CLAMP ASSEMBLY	1	EX-STOCK	To form a right-angle connection between a 32 mm diameter pole & a 38 mm diameter pole.
15	FA62058	IN - LINE JOINT ASSEMBLY		Obsolete	To join together two 32 mm diameter poles end to end.
16	FA62055	PRINthead MOUNTING POLE - 1.0 M	1	EX-STOCK	
16	FA62056	PRINthead MOUNTING POLE - 0.5 M	1	EX-STOCK	
17	FA62068	PRINthead WASH STATION	1	EX-STOCK	Bolts onto 32 mm diameter mounting poles or can be screwed to a support.
	FA77119	SLEEVE 38 MM TO 32 MM		Obsolete	Adaptor rings for wash stations 38mm poles for 32mm diameter mounting poles.

Linx Continuous Ink Jet Printers
Section 16 - Accessories - Standard Printhead Stands

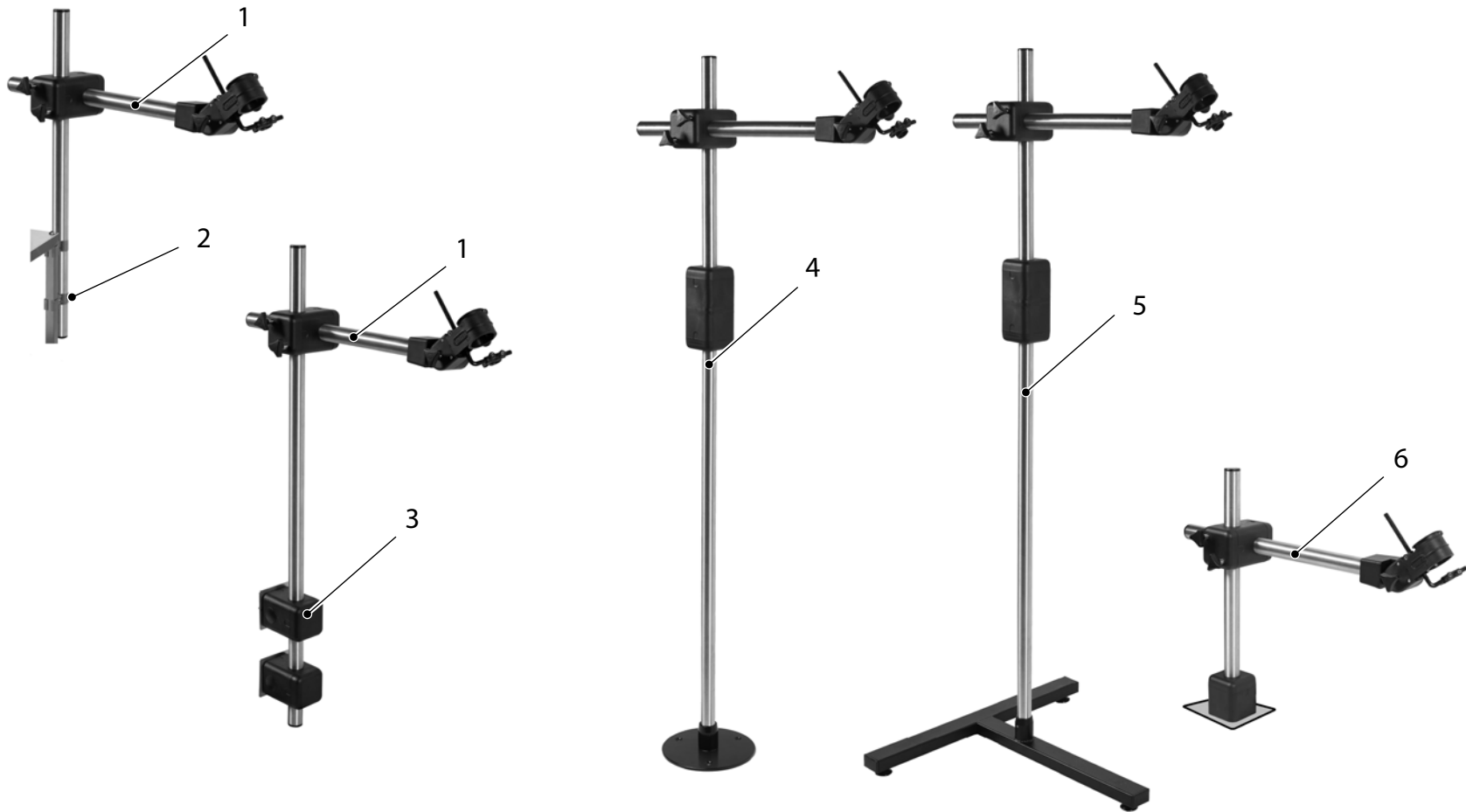

Item	Part Num	Description	Qty	Availability	Comments
1	FA62203	P/H MOUNTING ASSY - DIRECTUVERTICAL	1	EX-STOCK	
2	FA62197	PRINTER TROLLEY CLAMP SET	1	EX-STOCK	See PB0683 for details.
3	FA62211	DIRECTUVERTICAL MOUNT TROLLEY ADAPTOR SUB-ASSY	1	EX-STOCK	
4	FA62200	P/H MOUNTING ASSY - FLOOR MOUNTED FIXED	1	EX-STOCK	

Linx Continuous Ink Jet Printers

Section 16 - Accessories - Standard Printhead Stands



Item	Part Num	Description	Qty	Availability	Comments
5	FA62201	P/H MOUNTING ASSY - FLOOR MOUNTED MOBILE	1	EX-STOCK	
6	FA62202	P/H MOUNTING ASSY - DIRECT HORIZONTAL	1	EX-STOCK	

Linx Continuous Ink Jet Printers
Section 16 - Accessories - Standard Printhead Stands Accessories

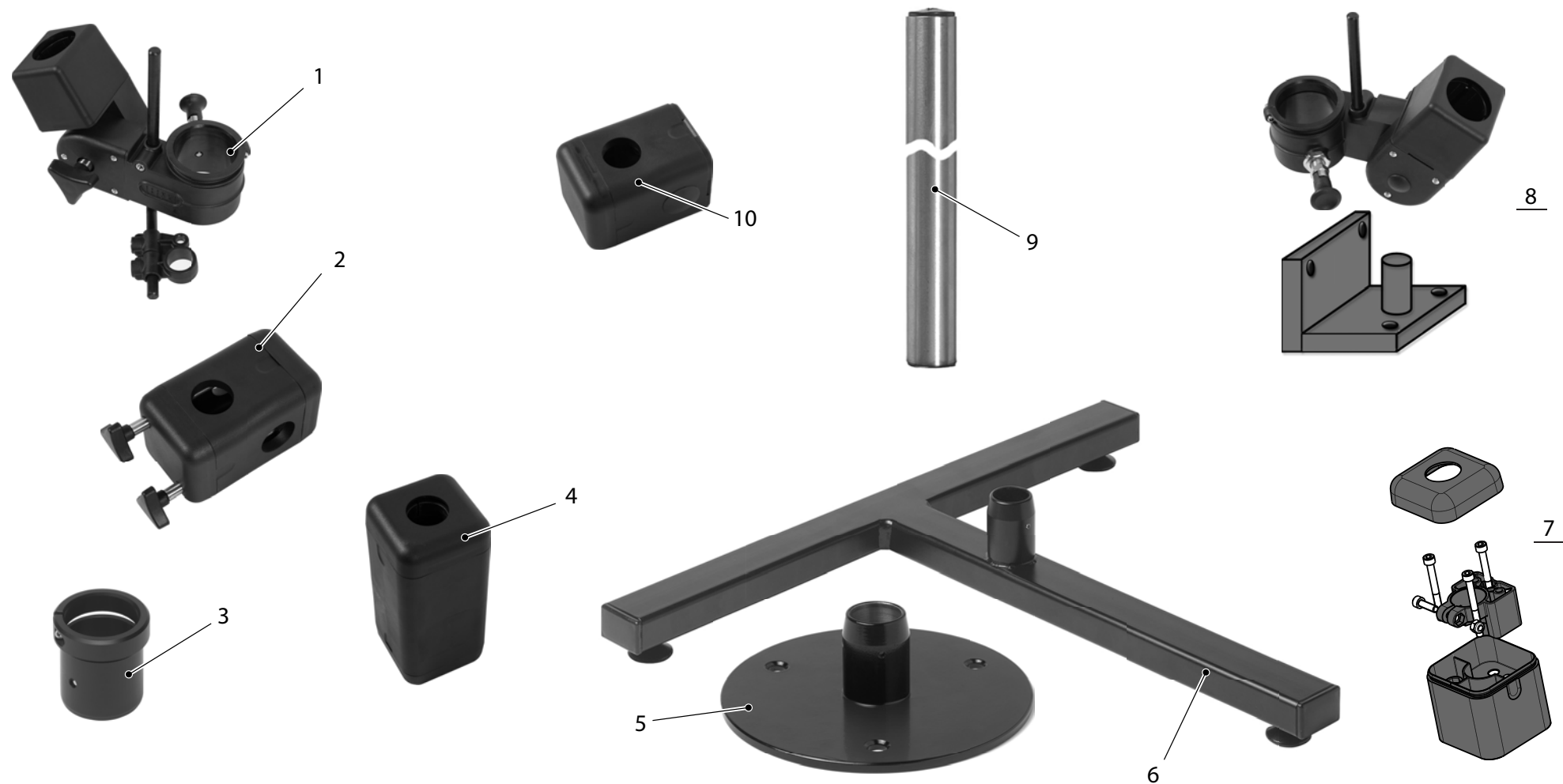

Item	Part Num	Description	Qty	Availability	Comments
1	FA62204	P/H BRACKET - HANDSCREW POLE MOUNT	1	EX-STOCK	
2	FA62209	HANDSCREW ADJUSTABLE CROSS JOINT	1	EX-STOCK	
3	FA62213	PRINthead SLEEVE	1	EX-STOCK	
4	FA62210	IN-LINE JOINT ASSEMBLY	1	EX-STOCK	

Linx Continuous Ink Jet Printers

Section 16 - Accessories - Standard Printhead Stands Accessories



Item	Part Num	Description	Qty	Availability	Comments
5	FA62051	BASE - FLOOR MOUNT, FIXED	1	EX-STOCK	
6	FA62052	BASE - FLOOR MOUNT, MOBILE	1	EX-STOCK	
7	FA62208	BASE - DIRECT HORIZONTAL MOUNT FIXED	1	EX-STOCK	
8	FA62205	P/H BRACKET - FIXED DIRECT MOUNT		Obsolete	
9	FA62056	PRINthead MOUNTING POLE - 0.5 M	1	EX-STOCK	
	FA62055	PRINthead MOUNTING POLE - 1.0 M	1	EX-STOCK	
10	FA62206	BASE - DIRECTUVERTICAL MOUNT FIXED	1	EX-STOCK	

Linx Continuous Ink Jet Printers
Section 16 - Accessories - Product Sensors

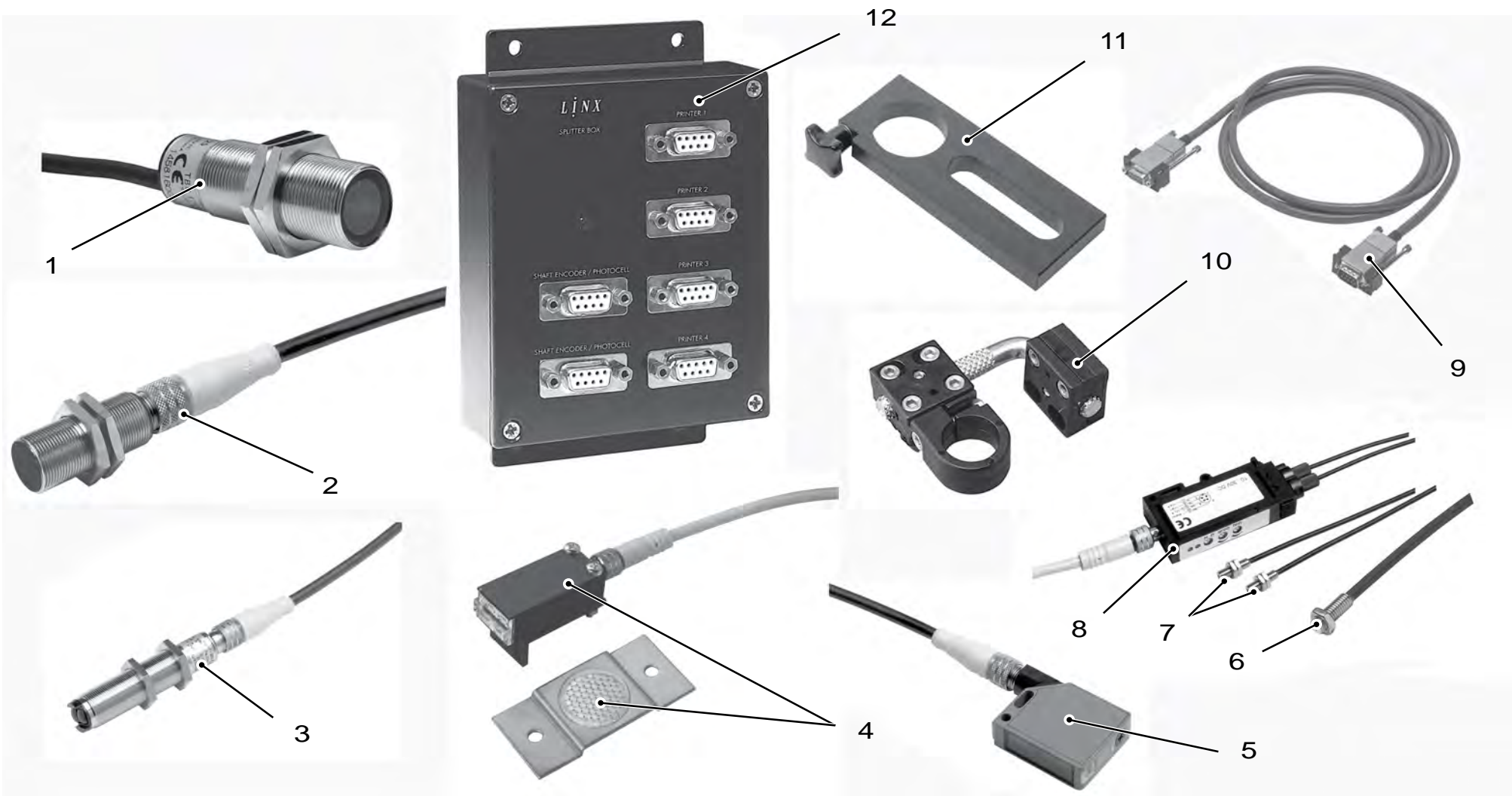

Item	Part Num	Description	Qty	Availability	Comments
1	FA61105	REFLECT LIGHT BEAM SCAN-IP67 D 5M	1	EX-STOCK	Replaces FA61062.
1	FA61104	REFLECTION LIGHT BEAM SCANNER - MIL 5M	1	EX-STOCK	Replaces FA61061.
2	FA61100	INDUCTIVE SENSOR,IP67 D 5M	1	EX-STOCK	For use with all CIJ printers except 6200S & 6000S.
3	FA61079	BACKGROUND SUPPRESSION SENSOR, IP67 D 5M	1	EX-STOCK	For use with all CIJ printers except 6200S & 6000S.

Linx Continuous Ink Jet Printers

Section 16 - Accessories - Product Sensors



Item	Part Num	Description	Qty	Availability	Comments
3	FA61080	BACKGROUND SUPPRESSION SENSOR, MIL 5M		Obsolete	
4	FA61107	RETRO REFLECTION LIGHT BEAM SWITCH - MIL 5M	1	EX-STOCK	Replaces FA61049 & FA61102..
4	FA61108	RETRO REFLECTION LIGHT BEAM SWITCH - IP67D 5M	1	EX-STOCK	Replaces FA61050.
5	FA61077	REGISTRATION MARK SCANNER, IP67 D 5M	1	EX-STOCK	For use with all CIJ printers except 6200S & 6000S.
5	FA61078	REGISTRATION MARK SCANNER, MIL 5M	1	EX-STOCK	For use with 6200S & 6000S printers.
6	FA536002	FIBRE OPTIC - REFLECTION (1X2M CABLE)	1	EX-STOCK	For use with fibre optic control unit with connector suitable for printer type.
7	FA536001	FIBRE OPTIC - THROUGH BEAM (2X2M CABLES)		Obsolete	
	FA63069	FIBRE OPTIC - THROUGH BEAM (2X2M CABLES)	1	EX-STOCK	For use with fibre optic control unit with connector suitable for printer type.
8	FA63031	FIBRE OPTIC CONTROL UNIT - IP67 D 5M		Obsolete	
	FA63068	FIBRE OPTIC CONTROL UNIT - IP67 D 5M	1	EX-STOCK	Not 6200S & 6000S. Select either through-beam or reflection type fibre optic sensor.
8	FA63030	FIBRE OPTIC CONTROL UNIT - MIL 5M		Obsolete	
	FA63067	FIBRE OPTIC CONTROL UNIT - MIL XM	1	EX-STOCK	Not 6200S & 6000S. Select either through-beam or reflection type fibre optic sensor.
9	FA16030	ADAPTER CABLE 0.1M - IP67 SOCKET TO MIL PLUG	1	ENQUIRE	For use with 6200,4800 & earlier printers only.
9	FA63035	ADAPTER CABLE 0.1M - MIL SOCKET TO IP67 PLUG	1	EX-STOCK	Suitable to item with a MIL connector for any printer except 6200S.
9	FA63034	EXTENSION CABLE 2M - IP67 D	1	EX-STOCK	Comprises female IP67 connector & male IP67 connector.
9	FA63036	EXTENSION CABLE 2M - MIL		Obsolete	Comprises female military connector & male military connector.
10	FA099050	SENSOR MOUNTING BRACKET	1	EX-STOCK	Suitable for mounting M18 sensors onto a production line.
11	FA62035	SENSOR COVER TUBE MOUNTING BRACKET	1	EX-STOCK	Suitable for mounting M18 sensors onto the printhead cover tube.
12	FA63012	P/CELL & S/E SPLITTER BOX 4-WAY D-TYPE	1	EX-STOCK	Enables up to four printers to be triggered by one sensor &/or encoder.Has 4x2m cables.

Linx Continuous Ink Jet Printers
Section 16 - Accessories - Shaft Encoders and Wheels

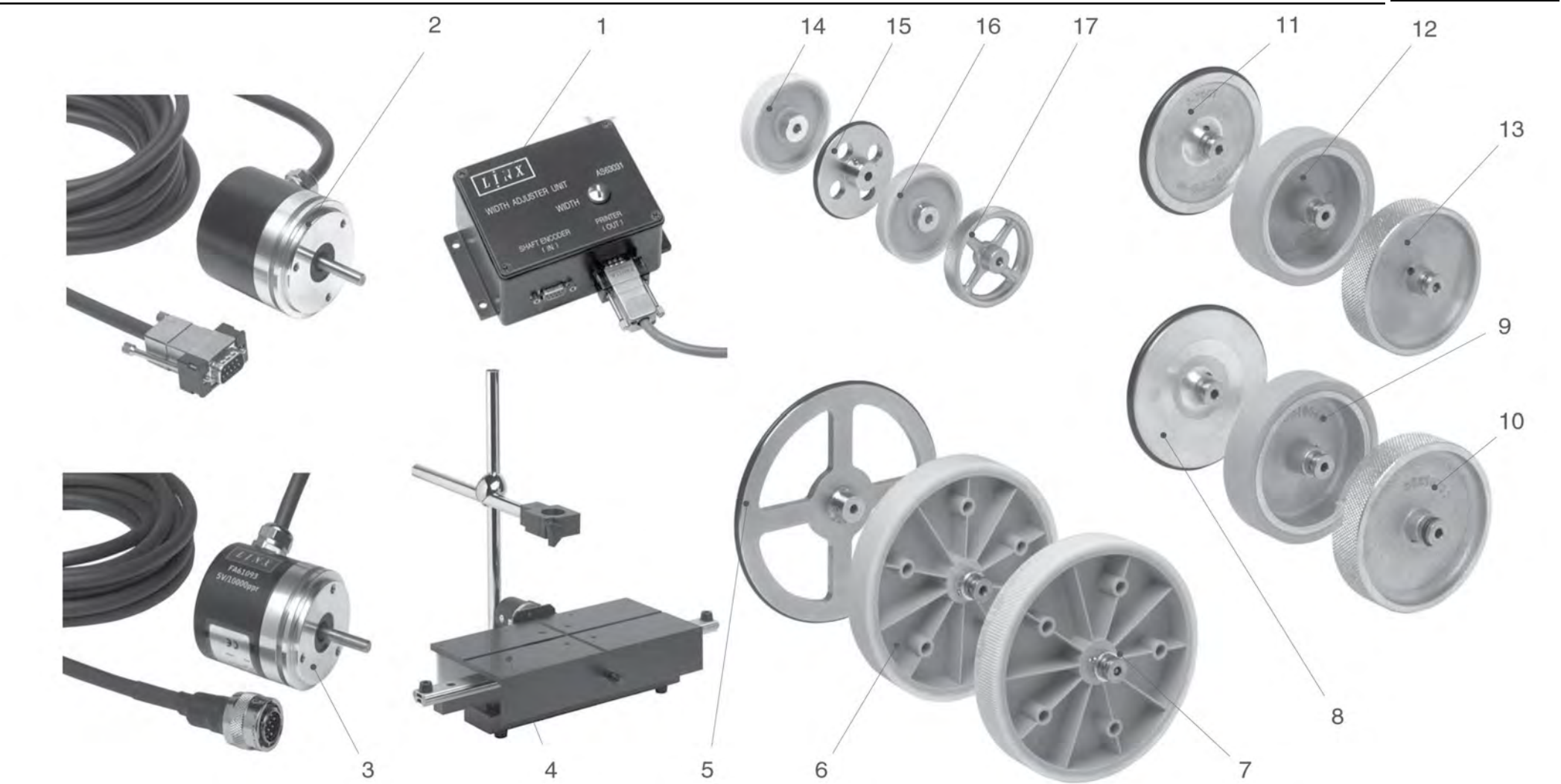

Item	Part Num	Description	Qty	Availability	Comments
1	FA63023	WIDTH ADJUSTER AND SHAFT ENCODER - IP67 D		Obsolete	
1	FA63024	WIDTH ADJUSTER AND SHAFT ENCODER - MIL		Obsolete	
2	FA61110	SHAFT ENCODER-2500PPR-IP67	1	EX-STOCK	Replaces FA61088.
2	FA61111	SHAFT ENCODER-2500PPR-MIL	1	EX-STOCK	Replaces FA61089.

Linx Continuous Ink Jet Printers

Section 16 - Accessories - Shaft Encoders and Wheels



Item	Part Num	Description	Qty	Availability	Comments
2	FA61112	SHAFT ENCODER-5000PPR-IP67	1	EX-STOCK	Replaces FA61090.
3	FA61113	SHAFT ENCODER-5000PPR-MIL	1	EX-STOCK	Replaces FA61091.
3	FA61114	SHAFT ENCODER-10000PPR-IP67	1	EX-STOCK	Replaces FA61092.
3	FA61115	SHAFT ENCODER-10000PPR-MIL	1	EX-STOCK	Replaces FA61093.
4	FA69002	HAND TRANSPORT	1	EX-STOCK	Includes encoder FA61088,sensor FA61062 & adaptor cable.
4	FA69016	REPLACEMENT ENCODER WHEEL - PACK	1	EX-STOCK	For h& transport.
5	FA910020	500MM WHEEL, RUBBER, 6MM WIDE	1	EX-STOCK	Adaptor wheel FA910046 may also be required.
6	FA910021	500MM WHEEL, POLYURETHANE, 24MM WIDE		Obsolete	Adaptor wheel FA910046 may also be required.
7	FA910042	500MM WHEEL, FLUTED HYTREL, 24MM WIDE	1	EX-STOCK	Adaptor wheel FA910046 may also be required.
8	FA910043	333MM WHEEL, RUBBER, 9MM WIDE	1	EX-STOCK	Adaptor wheel FA910030 may also be required.
9	FA910044	333MM WHEEL, POLYURETHANE, 25MM WIDE		Obsolete	Adaptor wheel FA910030 may also be required.
10	FA910045	333MM WHEEL, KNURLED ALUMIN, 25MM WIDE	1	Last stock	Adaptor wheel FA910030 may also be required.
11	FA910027	1FT WHEEL, RUBBER, 9MM WIDE	1	EX-STOCK	Adaptor wheel FA910030 may also be required.
12	FA910028	1FT WHEEL, POLYURETHANE, 25MM WIDE		Obsolete	For smooth materials that may mark. Adaptor wheel FA910030 may also be required.
13	FA910029	1FT WHEEL, KNURLED ALUMIN, 25MM WIDE	1	EX-STOCK	Adaptor wheel FA910030 may also be required.
14	FA910006	200MM WHEEL, FLUTED HYTREL, 12MM WIDE	1	EX-STOCK	Is constructed using hard-wearing materials.
15	FA910023	200MM WHEEL, RUBBER, 6MM WIDE	1	EX-STOCK	For smooth surfaces,wet surfaces,materials that may mark,& narrow tracks.
16	FA910024	200MM WHEEL, POLYURETHANE, 24MM WIDE	1	EX-STOCK	For smooth materials & materials that may mark.
17	FA910025	200MM WHEEL, KNURLED ALUMIN, 11.5MM WIDE	1	EX-STOCK	For rubber,coarse-weave textiles,wood & foam.

Linx Continuous Ink Jet Printers

Section 16 - Accessories - Shaft Encoders Accessories

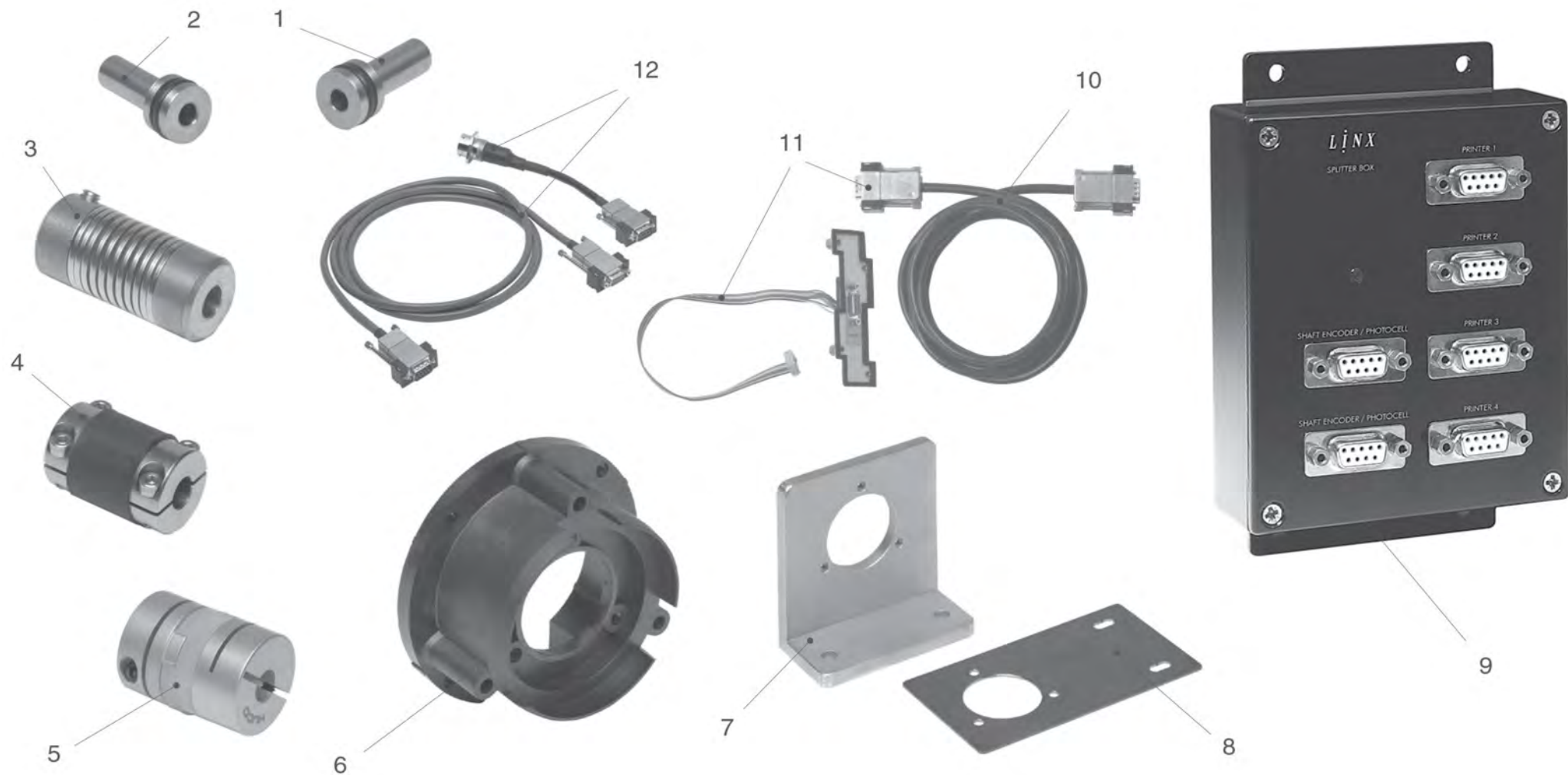

Item	Part Num	Description	Qty	Availability	Comments
1	FA910030	16MM ADAPTOR WHEEL (9.6MM TO 6MM)	1	EX-STOCK	Changes hole from 9.6 to 6.0mm for encoder shaft. Also is 50 mm circumference wheel.
2	FA910046	16MM ADAPTOR WHEEL (10MM TO 6MM)	1	EX-STOCK	Changes hole from 10 to 6.0mm for encoder shaft. Also is 50 mm circumference wheel.
3	FA910039	SPRING COUPLING - STAINLESS	1	EX-STOCK	General purpose coupling for hygiene critical applications. Replaces BP910015.
4	FA910040	SPRING COUPLING - ALUMINIUM	1	EX-STOCK	General purpose coupling.

Linx Continuous Ink Jet Printers

Section 16 - Accessories - Shaft Encoders Accessories



Item	Part Num	Description	Qty	Availability	Comments
5	FA910041	OLDHAM COUPLING	1	EX-STOCK	A short coupling for mounting on the ends of shafts, especially with the bell housing.
6	FA910034	BELL HOUSING	1	EX-STOCK	To mount the encoder onto the ends of shafts using the Oldham coupling.
7	FA61096	L - SHAPED FLANGE	1	EX-STOCK	To hold the encoder at a right-angle to the production line mounting surface.
8	FA61098	FLAT FLANGE	1	EX-STOCK	To install an encoder into a restricted space. Replaces BP910011.
9	FA63012	P/CELL & S/E SPLITTER BOX 4-WAY D-TYPE	1	EX-STOCK	Enables up to four printers to be triggered by one sensor &/or encoder. Has 4x2m cables.
10	FA63040	PDEM CABLEFORM 2M D - D IP67	1	EX-STOCK	Connects two 6800 and later printers to share photocells and shaft encoders
11	FA63025	PRODUCT DETECTOR/ENCODER MULTIPLEXER	1	EX-STOCK	Enables multiple printers to be triggered together. See 6800 Maint. Manual.
	FA63038	PRODUCT DETECTOR/ENCODER MUX	1	EX-STOCK	See Linx 6900, Maintenance Manual for details of use.
12	FA16030	ADAPTER CABLE 0.1M - IP67 SOCKET TO MIL PLUG	1	ENQUIRE	For use with 6200, 4800 & earlier printers only.
12	FA63035	ADAPTER CABLE 0.1M - MIL SOCKET TO IP67 PLUG	1	EX-STOCK	Suitable to item with a MIL connector for any printer except 6200S.
12	FA63034	EXTENSION CABLE 2M - IP67 D	1	EX-STOCK	Comprises female IP67 connector & male IP67 connector.
12	FA63036	EXTENSION CABLE 2M - MIL		Obsolete	Comprises female military connector & male military connector.

Linx Continuous Ink Jet Printers
Section 16 - Accessories - Width Adjuster Unit

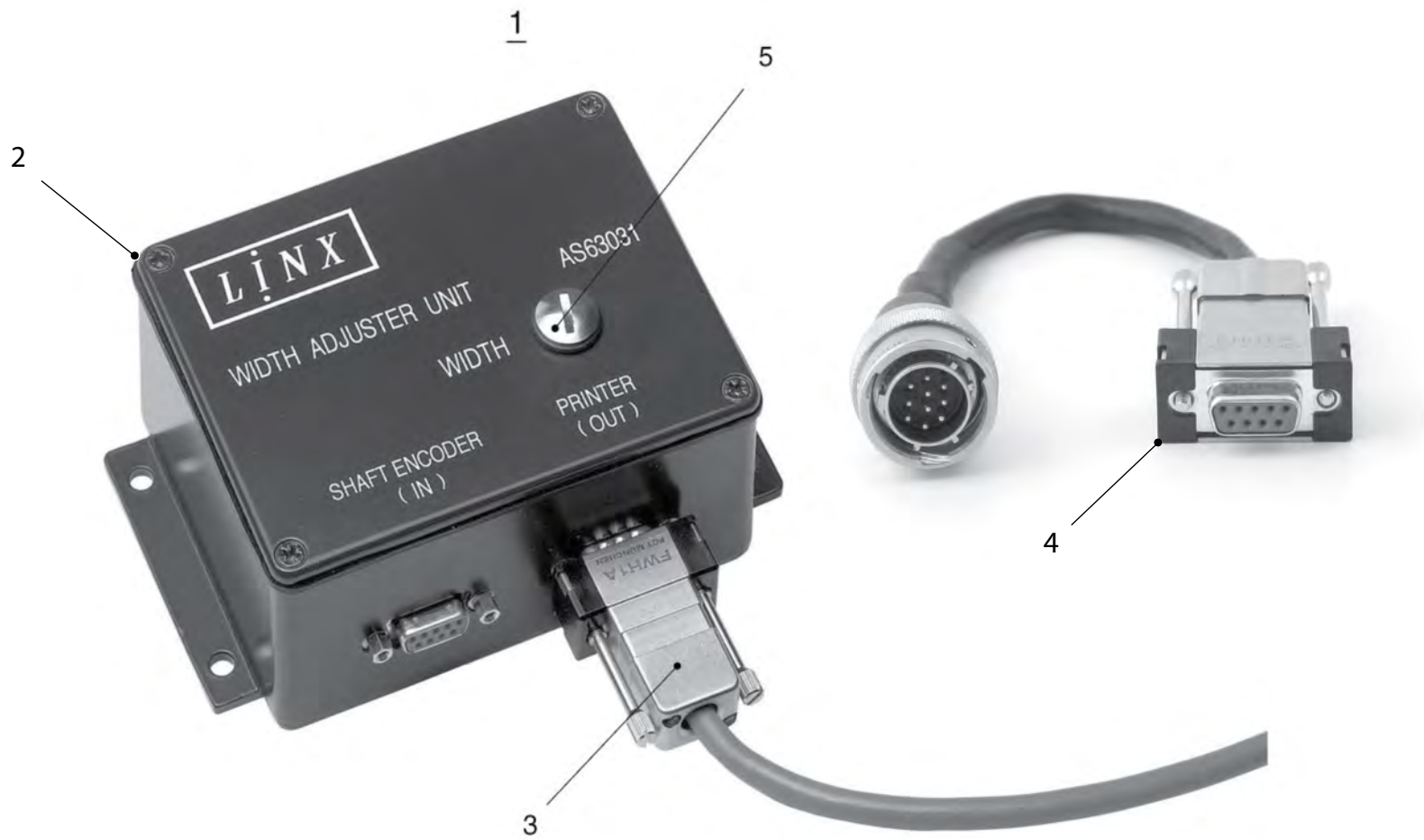

Item	Part Num	Description	Qty	Availability	Comments
1	FA63021	WIDTH ADJUSTER UNIT - IP67 D	1	ENQUIRE	For printers up to 6200R,4800 (not 6000S).Includes cable FA63032.Requires shaft encoder.
1	FA63023	WIDTH ADJUSTER AND SHAFT ENCODER - IP67 D		Obsolete	
1	FA63022	WIDTH ADJUSTER UNIT - MIL		Obsolete	
1	FA63024	WIDTH ADJUSTER AND SHAFT ENCODER - MIL		Obsolete	
2	FA74168	WIDTH ADJUSTER UNIT GASKET SET		Obsolete	

Linx Continuous Ink Jet Printers

Section 16 - Accessories - Width Adjuster Unit



Item	Part Num	Description	Qty	Availability	Comments
3	FA63032	AUXILIARY CABLE, IP67 D-TYPE,2M	1	ENQUIRE	For 6200,4800 & earlier printers. Width Adjuster Unit to Printer cableform.
4	FA16030	ADAPTER CABLE 0.1M - IP67 SOCKET TO MIL PLUG	1	ENQUIRE	For use with 6200,4800 & earlier printers only.
5	FA73186	WIDTH ADJUSTER UNIT BLIND PLUG	1	ENQUIRE	
	FA65362	WIDTH ADJUSTER UNIT USER GUIDE	1	ENQUIRE	

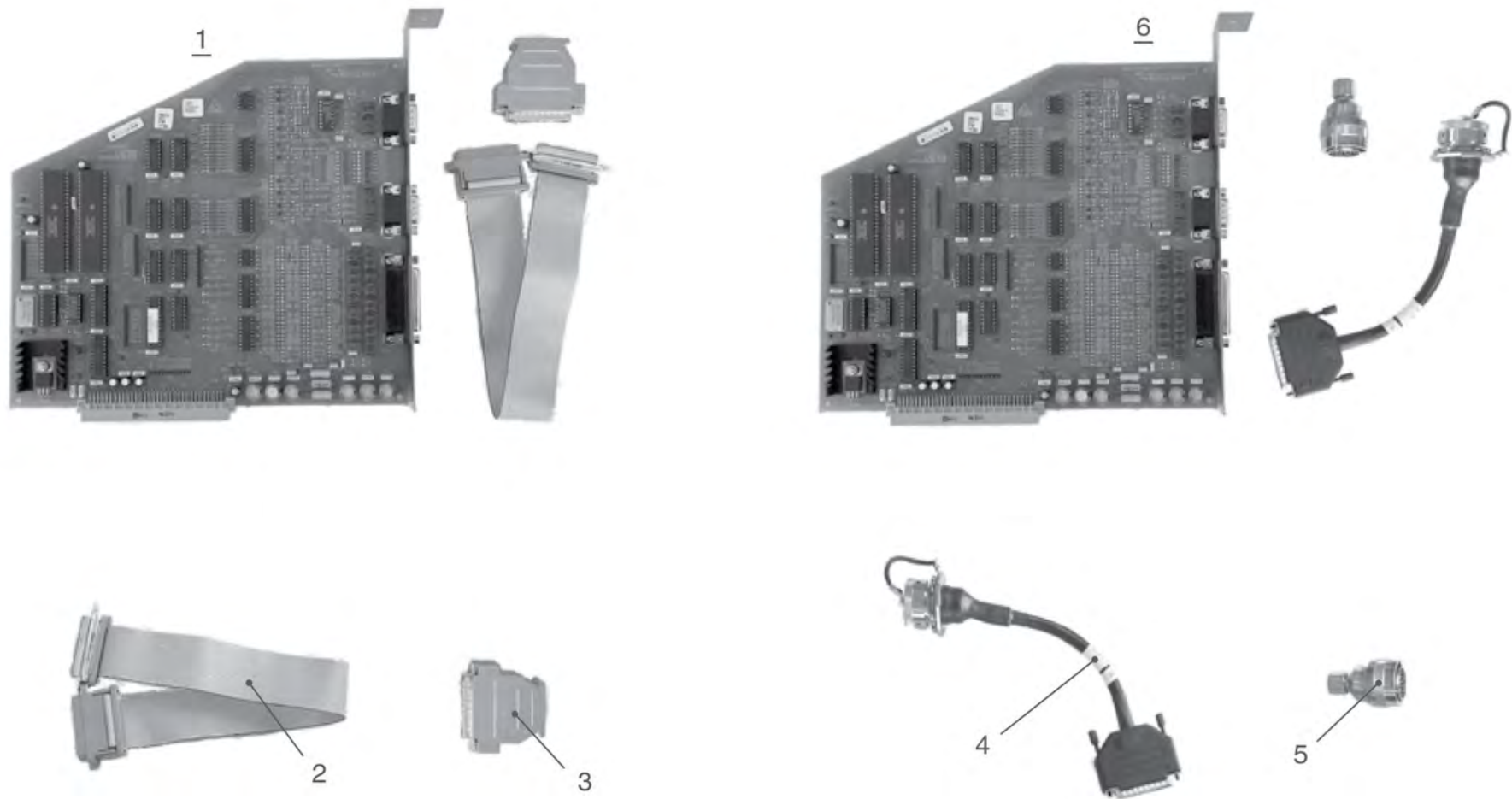

Item	Part Num	Description	Qty	Availability	Comments
1	FA63015	24 V PARALLEL I/O HARDWARE SET, 6200R		Obsolete	
2	FA63019	PIO CABLEFORM D-TYPE TO D-TYPE		Obsolete	Internal cableform.
3	FA63013	PIO D-TYPE CONNECTORS		Obsolete	Used to make cableform for external connection.
4	FA63020	PIO CABLEFORM D-TYPE TO MIL	1	EX-STOCK	Internal cableform.

Linx Continuous Ink Jet Printers

Section 16 - Accessories - Parallel IO Hardware



Item	Part Num	Description	Qty	Availability	Comments
5	FA63014	PIO MIL CONNECTORS		Obsolete	Used to make cableform for external connection.
6	FA63016	24 V PARALLEL I/O HARDWARE SET, 6200S		Obsolete	
	FA63009	24 V AUXILIARY I/O PCB ASSEMBLY		Obsolete	
	FA63037	EXTERNAL PARALLEL I/O MODULE	1	EX-STOCK	External device to provide Parallel IO for 4800,4900,6200 & 6800 printers.

Linx Continuous Ink Jet Printers

Section 16 - Accessories - Interfacing



Item	Part Num	Description	Qty	Availability	Comments
	FA79006	6200S RS232 USER EQUIPMENT	1	4 WEEKS	Refer to Service Bulletin SB0345).
	FA79007	6200R RS232 USER EQUIPMENT	1	4 WEEKS	Refer to Service Bulletin SB0345).
	FA67048	4800 RS232 USER EQUIPMENT	1	EX-STOCK	Contains PC cable & Linx Remote Communications Interface Manual CD.
	FA67041	4200 RS232 USER EQUIPMENT	1	EX-STOCK	Includes PC cable & Linx Remote Communications Interface Manual CD.
	FA13064	RS232 PC CABLE MIL 5M	1	EX-STOCK	For use with 6200S printers only.
	FA63029	RS232 PC CABLE D-TYPE 2M	1	EX-STOCK	For use with 4200 or 4800 printers. Note, this cable is not IP67 rated.
	FA63033	RS232 PC CABLE IP67 2M FULL HANDSHAKE	1	EX-STOCK	For use with 4800, 4900 & 6200R printers.
	FA63063	RS232 PC CABLE IP67 2M NO HANDSHAKE	1	EX-STOCK	For use with 6800 & later printers. For full handshake add FA63064.
	FA63064	RS232 PC ADAPTOR CABLE HANDSHAKE TO NO HANDSHAKE	1	EX-STOCK	Converts part number FA63033 from ?Full Handshake to ?No Handshake.
	FA69039	RS232 ADAPTOR CABLE MIL PLUG TO D PLUG 0.2 M LONG	1	EX-STOCK	Comprises male military connector & male IP67 connector.
	FA13016	RS232 ADAPTOR CABLE FORM D SOCKET TO MIL SOCKET 0.2M LONG	1	EX-STOCK	Not suitable for 6200S printers. Only suitable for dry environments
	FA16030	ADAPTER CABLE 0.1M - IP67 SOCKET TO MIL PLUG	1	ENQUIRE	For use with 6200, 4800 & earlier printers only.
	FA63035	ADAPTER CABLE 0.1M - MIL SOCKET TO IP67 PLUG	1	EX-STOCK	Suitable to item with a MIL connector for any printer except 6200S.
	FA63034	EXTENSION CABLE 2M - IP67 D	1	EX-STOCK	Comprises female IP67 connector & male IP67 connector.
	FA63036	EXTENSION CABLE 2M - MIL		Obsolete	Comprises female military connector & male military connector.
	FA67040	4200 RS232 DDE UPGRADE		Obsolete	

Linx Continuous Ink Jet Printers
Section 16 - Accessories - Miscellaneous

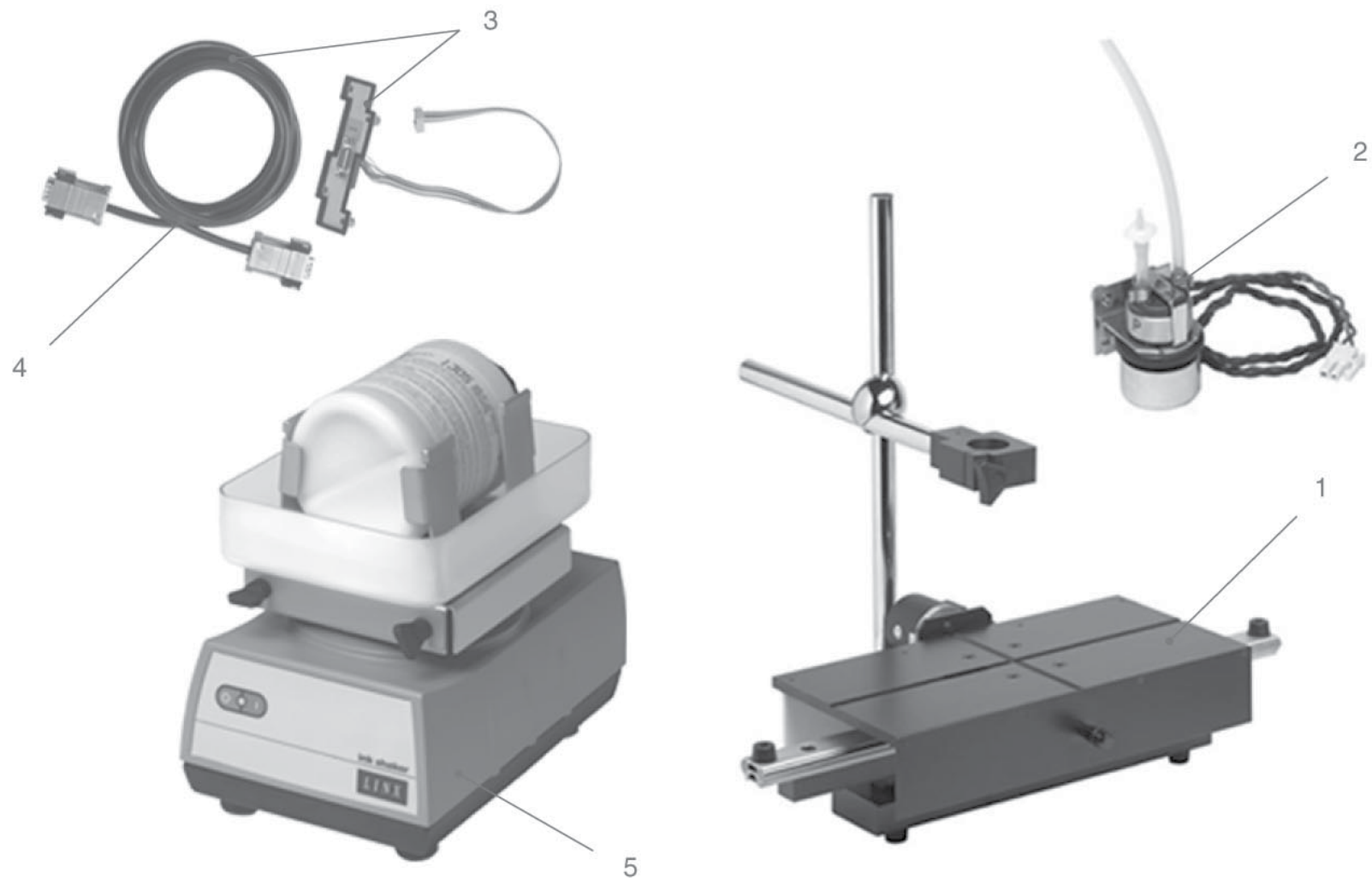

Item	Part Num	Description	Qty	Availability	Comments
1	FA69002	HAND TRANSPORT	1	EX-STOCK	Includes encoder FA61088,sensor FA61062 & adaptor cable.
1	FA69016	REPLACEMENT ENCODER WHEEL - PACK	1	EX-STOCK	For h& transport.
2	FA67050	POSITIVE AIR UPGRADE INTERNAL	1	EX-STOCK	Positive air pump for Mk7 printhead. Used in harsh environmental conditions.
2	FA67047	4800 INTERNAL POSITIVE AIR UPGRADE	1	EX-STOCK	For Mk5 Midi or Mk3B Micro printhead. Not suitable for use with Mk3B Macro printheads.

Linx Continuous Ink Jet Printers

Section 16 - Accessories - Miscellaneous



Item	Part Num	Description	Qty	Availability	Comments
	FA67053	4200/6200 POSITIVE AIR UPGRADE INTERNAL	1	EX-STOCK	Includes AS13546 Positive Air PCB (refer to Service Bulletin SB0461).
	FA69031	POSITIVE AIR PCB ASSEMBLY		Obsolete	
2	FA69005	4000/6000 EXTERNAL POSITIVE AIR UPGRADE		Obsolete	
3	FA63025	PRODUCT DETECTOR/ENCODER MULTIPLEXER	1	EX-STOCK	Enables multiple printers to be triggered together. See 6800 Maint. Manual.
	FA63038	PRODUCT DETECTOR/ENCODER MUX	1	EX-STOCK	See Linx 6900,Maintenance Manual for details of use.
4	FA63040	PDEM CABLEFORM 2M D - D IP67	1	EX-STOCK	Connects two 6800 and later printers to share photocells and shaft encoders
5	FA65040	INK SHAKER 230 V 50/60HZ	1	EX-STOCK	
5	FA65041	INK SHAKER 115 V 50/60HZ	1	EX-STOCK	
5	FA65042	INK SHAKER BOTTLE HOLDER ASSY	1	EX-STOCK	
	FA65479	INK SHAKER USER GUIDE	1	EX-STOCK	
	FA10504	MAINS CABLE IEC 230V - FREE END		Obsolete	
	FA69044	LINX CIJ PROTECTIVE COVER(5 PACK)	5	EX-STOCK	For 4900,5900,6800,6900,7300 & 7900 printers to protect them during normal usage.
	FA69021	PROTECTIVE PRINTER COVER ? 6200S	5	EX-STOCK	To be placed on 6200S or 6000S printers to protect them during normal usage.
	FA69022	PROTECTIVE PRINTER COVER ? 6200R	5	EX-STOCK	To be placed on 6200R or 6000R printers to protect them during normal usage.
	FA74129	PRINthead SPLASH COVER - PACK	20	EX-STOCK	To protect printheads against water ingress during wash down.



Item	Part Num	Description	Qty	Availability	Comments
1	FA74276	AIR CURTAIN KIT	1	EX-STOCK	Used in bottle coding applications.
2	FA72163	SPARE AIR NOZZLE	1	EX-STOCK	Includes screws & connector.

Linx Continuous Ink Jet Printers
Section 16 - Accessories - Option Plates for 6900 and later printers



6900 Printer Option Plate Possible Combinations :-

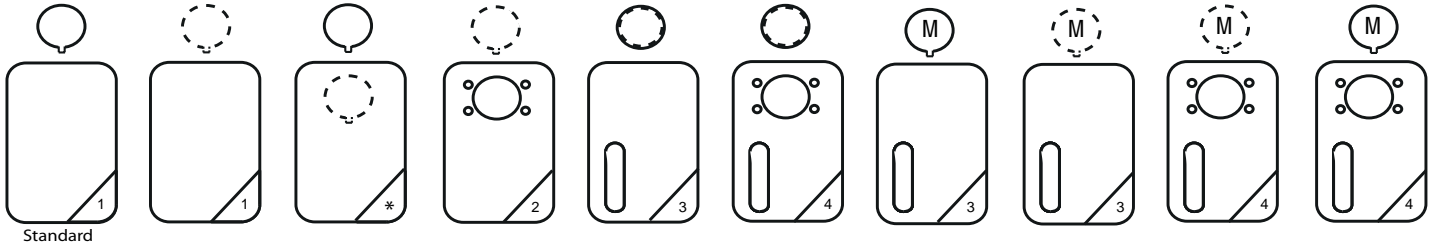

7300 Printer Option Plate Possible Combinations :-

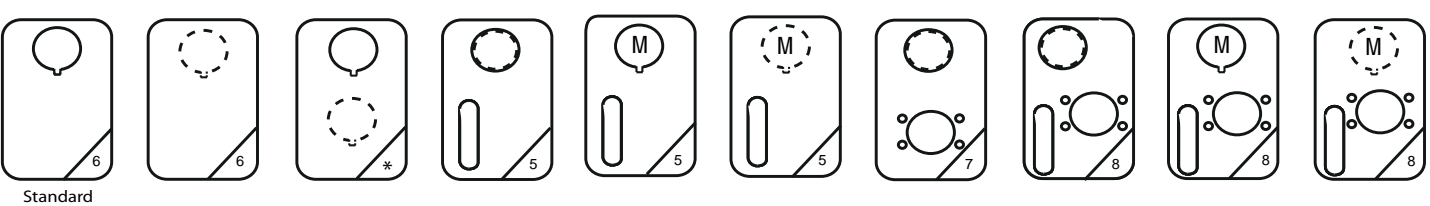

5900 Printer Option Plate Possible Combinations :-

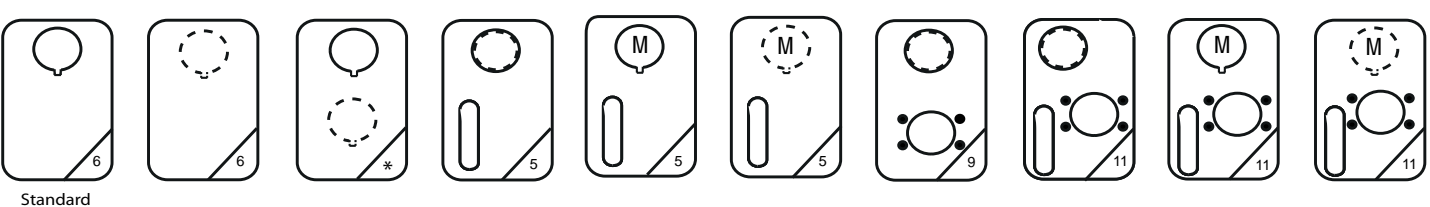

7900 Printer Option Plate Possible Combinations :-

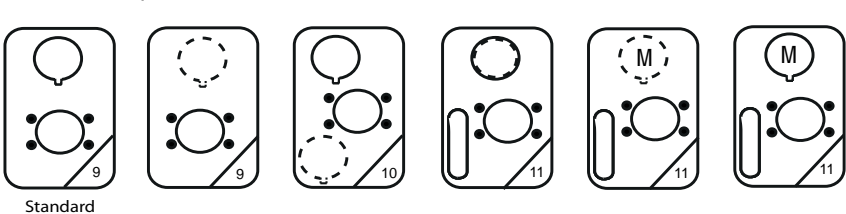

Key

24 v Alarm

Ethernet MK1

Ethernet MK2

VFC Alarm

24 v Alarm or VFC Alarm

Parallel IO

24 v MultiStage Alarm

VFC MultiStage Alarm

* Plate only available as part of Dual Alarm Assembly

Item	Part Num	Description	Qty	Availability	Comments
1	FA72158	6900 BLANKING PLATE	1	EX-STOCK	Includes gasket & screws.
2	FA67070	6900 OPTION PLATE - ETHERNET ASST SPARE	1	EX-STOCK	Includes gasket & screws.
3	FA67073	6900 OPTION PLATE - PARALLEL I/O ASSY SPARE	1	EX-STOCK	Includes gasket & screws.
4	FA67067	6900 OPTION PLATE - COMBINED ETHERNET/PIO	1	EX-STOCK	Includes gasket & screws.

Linx Continuous Ink Jet Printers

Section 16 - Accessories - Option Plates for 6900 and later printers



Item	Part Num	Description	Qty	Availability	Comments
5	FA72167	5900/7300 ALARM & PIO OPTIONS PLATE	1	EX-STOCK	Includes gasket & screws.
6	FA72165	5900/7300 STANDARD BLANKING PLATE	1	EX-STOCK	Includes gasket & screws.
7	FA72166	5900/7300 ALARM & ETHERNET OPTION PLATE	1	EX-STOCK	Includes gasket & screws.
8	FA72168	5900/7300 ALARM ,PIO & ETHERNET OPTIONS PLATE	1	EX-STOCK	Includes gasket & screws.
9	FA72173	5900/7900 OPTION PLATE FOR ALARM AND ETHERNET.	1	EX-STOCK	Includes gasket & screws.
10	FA72184	5900/7900 DUAL OPTION PLATE	1	EX-STOCK	Includes gasket & screws.
11	FA72185	5900/7900 PARALLEL IO OPTION PLATE	1	EX-STOCK	Includes gasket & screws.

Linx Continuous Ink Jet Printers

Section 16 - Accessories - Main Option Plate Accessories for 6900 and later printers



Item	Part Num	Description	Qty	Availability	Comments
	Note	Refer to spreadsheet to choose correct accessory for 6900 and later printers.			
		Spreadsheet is located in PDF portfolio that contains this document.			
	FA13547	ALARM CABLEFORM & PCB	1	EX-STOCK	Without option plate. Replacement for standard 24 v Alarm.
	FA67060	6900 ETHERNET UPGRADE+OPTION PLATE	1	EX-STOCK	
	FA67063	6900 PARALLEL I/O UPGRADE	1	EX-STOCK	
	FA67064	MULTI-STAGE ALARM (24 V) UPGRADE ASSY	1	EX-STOCK	Requires a Parallel I/O.
	FA67065	MULTI-STAGE ALARM (VFC) UPGRADE ASSY	1	EX-STOCK	Requires a Parallel I/O.
	FA67075	6900 DUAL ALARM UPGRADE	1	EX-STOCK	
	FA67077	5900/7300 DUAL ALARM UPGRADE ASSY	1	EX-STOCK	
	FA67078	PARALLEL IO UPGRADE	1	EX-STOCK	Without option plate.
	FA67079	ETHERNET ASSY	1	EX-STOCK	Without option plate. For 6900 and 7300 printers.
	FA67082	5900/7300 PARALLEL I/O UPGRADE	1	EX-STOCK	
	FA67083	7300 ETHERNET UPGRADE	1	EX-STOCK	
	FA67084	7300 PARALLEL I/O+ETHER UPGRADE	1	EX-STOCK	
	FA67085	5900/7300 PARALLEL I/O+VFC ALARM UPGRADE	1	EX-STOCK	
	FA67086	7300 ETHERNET+VFC ALARM UPGRADE	1	EX-STOCK	
	FA67087	7300 PARALEL I/O+VFC ALARM+ETH UPGRADE	1	EX-STOCK	
	FA67088	5900/7300 PARALLEL I/O+24 V M/ALARM UPGR	1	EX-STOCK	
	FA67089	5900/7300 PARALLEL I/O+VFC M/ALARM UPGR	1	EX-STOCK	
	FA67090	7300 PARA I/O+VFC M/ALARM+ETH UPGR	1	EX-STOCK	
	FA67091	7300 PARA I/O+24 V M/ALARM+ETH UPGR	1	EX-STOCK	
	FA67095	5900 ETHERNET +VFC ALARM +OP PLATE	1	EX-STOCK	
	FA67096	5900 ETHERNET +CABLE/PLUG/CAP/PLATE	1	EX-STOCK	
	FA67097	5900 PARALLEL I/O AND ETHERNET	1	EX-STOCK	
	FA67098	5900 PARA.I/O & ENET+ S.STAGE VFC	1	EX-STOCK	
	FA67099	5900 PARA.I/O & ENET+ M.STAGE 24V	1	EX-STOCK	
	FA67100	5900 PARA.I/O & ENET+ M.STAGE VFC	1	EX-STOCK	
	FA71080	VFC ALARM CONVERSION	1	EX-STOCK	Without option plate. Kit reuses existing Alarm PCB.
	FA72177	5900/7900 DUAL ALARM UPGRADE CHANGE	1	EX-STOCK	
	FA72178	5900/7900 PARALLEL I/O INTERFACE UPGRADE	1	EX-STOCK	
	FA72179	5900/7900 VFC ALARM AND PARALLEL I/O UPGRADE	1	EX-STOCK	

Linx Continuous Ink Jet Printers

Section 16 - Accessories - Main Option Plate Accessories for 6900 and later printers



Item	Part Num	Description	Qty	Availability	Comments
	FA72180	5900/7900 MULTI-STAGE ALARM (24 V) AND PARALLEL I/O INTERFACE	1	EX-STOCK	
	FA72181	5900/7900 MULTI-STAGE ALARM (VFC) AND PARALLEL I/O INTERFACE	1	EX-STOCK	

Linx Continuous Ink Jet Printers

Section 16 - Accessories - Single Stage Alarms for 6900 and later printers

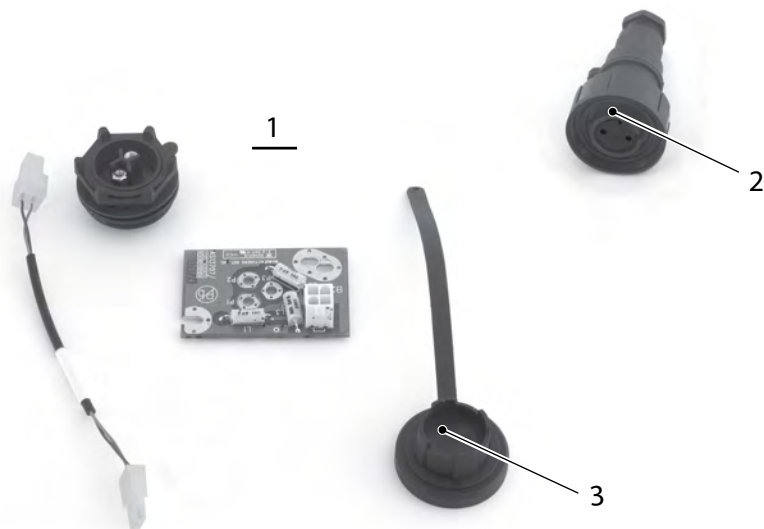

Notes:

Item 1 includes nuts, pillars etc.

It is a replacement for the 24 v single stage alarm output that is standard with the printer. Connects to Linx single stage alarms.

Item 2 (24 v Alarm Connector) is not included with Item 1.

Item 3 (Dust Cap) is included with Item 1.

Notes:

Item 4 includes nuts, pillars etc. It provides the parts to convert a 24 v single stage alarm output to a single stage VFC (Volt Free Contact) alarm output. This provides one output to user supplied equipment such as a beacon or PLC.

The existing alarm PCB is reused.

Item 5 VFC Alarm Connector is included with item 4

Item 3 Alarm Cap is available separately.



Item	Part Num	Description	Qty	Availability	Comments
1	FA13547	ALARM CABLEFORM & PCB	1	EX-STOCK	Without option plate. Replacement for standard 24 v Alarm.
2	FA69007	2-WAY ALARM CONN IP67 (TUV)	1	EX-STOCK	2-pin plug to connect to external alarm device.
3	FA72175	ALARM CAP	1	EX-STOCK	
4	FA71080	VFC ALARM CONVERSION	1	EX-STOCK	Without option plate. Kit reuses existing Alarm PCB.

Linx Continuous Ink Jet Printers

Section 16 - Accessories - Single Stage Alarms for 6900 and later printers



Item	Part Num	Description	Qty	Availability	Comments
5	FA69007	2-WAY ALARM CONN IP67 (TUV)	1	EX-STOCK	2-pin plug to connect to external alarm device.

Linx Continuous Ink Jet Printers

Section 16 - Accessories - Ethernet for 6900 and later printers



MK1 Ethernet used
in 6900 and 7300
printers

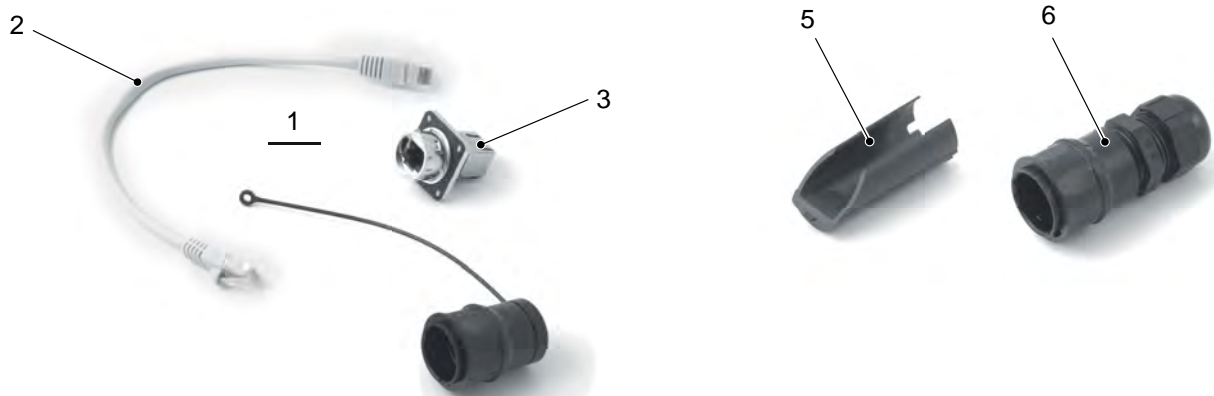

MK2 Ethernet used
in 5900 and 7900
printers



Item	Part Num	Description	Qty	Availability	Comments
1	FA67079	ETHERNET ASSY	1	EX-STOCK	Without option plate. For 6900 and 7300 printers.
2	FA67069	ETHERNET PATCH LEAD, CAT5E BEIGE 0.3M RJ45	1	EX-STOCK	Internal Ethernet cable.
3	FA67068	RJ 544 ETHERNET CONNECTOR ASSY SPARE	1	EX-STOCK	Replacement connector.
4	FA72176	5900/7900 ETHERNET CAP	1	EX-STOCK	

Linx Continuous Ink Jet Printers

Section 16 - Accessories - Ethernet for 6900 and later printers



Item	Part Num	Description	Qty	Availability	Comments
5	FA67062	RJF 544 ETHERNET CON PLUG REMOVAL TOOL	1	EX-STOCK	Tool to remove connector from FA67061. Includes instructions.
6	FA67061	RJF 544 ETHERNET CON PLASTIC CABLE PLUG	1	EX-STOCK	Protects a standard RJ45 cord set from shocks,dust & moisture.
7	FA72187	5900/7900 ETHERNET CONNECTOR	1	EX-STOCK	
8	FA67096	5900 ETHERNET +CABLE/PLUG/CAP/PLATE	1	EX-STOCK	
9	FA72174	7900 ETHERNET IP67	1	EX-STOCK	

Linx Continuous Ink Jet Printers

Section 16 - Accessories - Dual Alarms for 6900 and later printers



Notes:

Item have all the items on this page, and the nuts, pillars etc. It also contains a suitable option plate depending upon which part number is chosen.

It adds an additional single stage VFC output in addition to the existing 24 v output.

The existing printer 24 v alarm and Ethernet hardware (where present) is reused.

The VFC (Volt Free Contact) output provides one output to customer supplied equipment such as a beacon or PLC.

Dual Alarm configuration codes are required. See Software Section for details.



Item	Part Num	Description	Qty	Availability	Comments
1	FA67075	6900 DUAL ALARM UPGRADE	1	EX-STOCK	
1	FA72177	5900/7900 DUAL ALARM UPGRADE CHANGE	1	EX-STOCK	
1	FA67077	5900/7300 DUAL ALARM UPGRADE ASSY	1	EX-STOCK	
4	FA72186	VFC ALARM CONNECTOR	1	EX-STOCK	

Linx Continuous Ink Jet Printers
Section 16 - Accessories - Parallel IO for 6900 and later printers

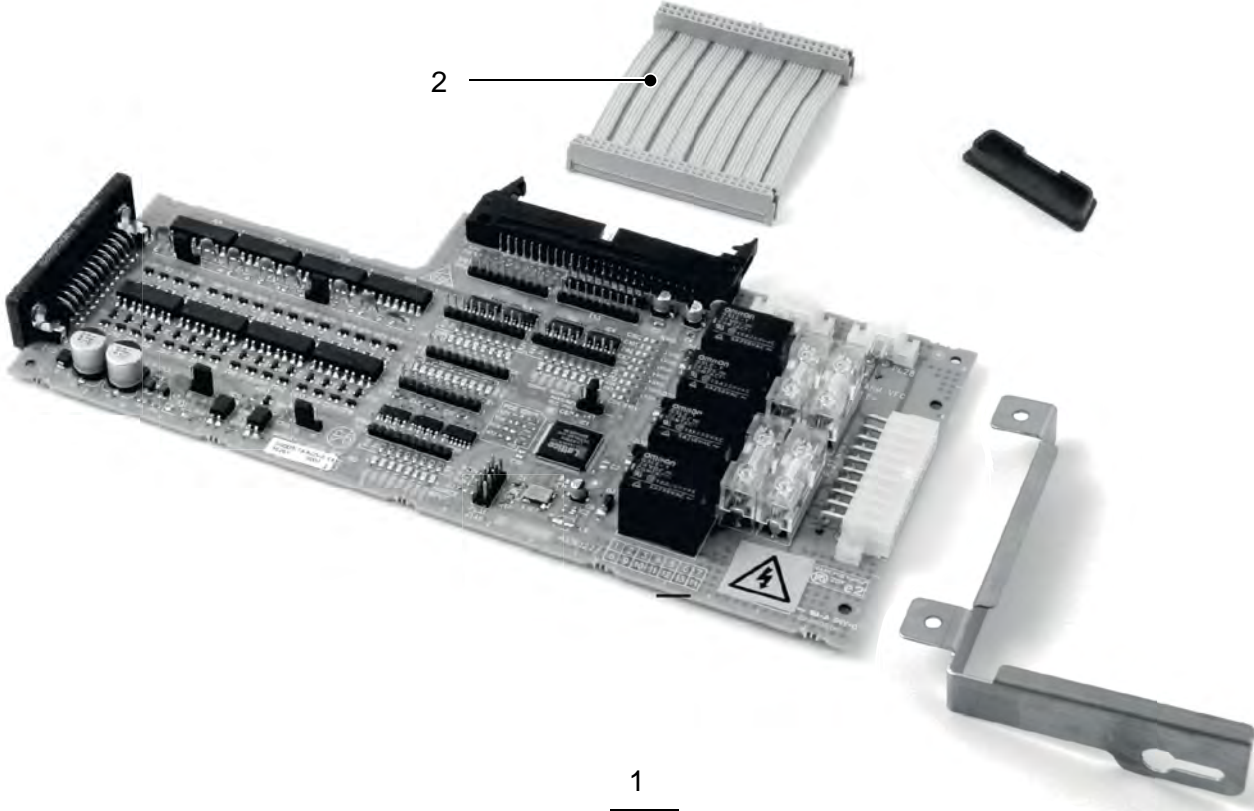

Item	Part Num	Description	Qty	Availability	Comments
1	FA67063	6900 PARALLEL I/O UPGRADE	1	EX-STOCK	
1	FA67082	5900/7300 PARALLEL I/O UPGRADE	1	EX-STOCK	
1	FA72178	5900/7900 PARALLEL I/O INTERFACE UPGRADE	1	EX-STOCK	
1	FA67078	PARALLEL IO UPGRADE	1	EX-STOCK	Without option plate.

Linx Continuous Ink Jet Printers

Section 16 - Accessories - Parallel IO for 6900 and later printers



Item	Part Num	Description	Qty	Availability	Comments
5	FA67072	PARALLEL I/O INTERFACE CABLE	1	EX-STOCK	

Linx Continuous Ink Jet Printers
Section 16 - Accessories - MultiStage Alarms for 6900 and later printers

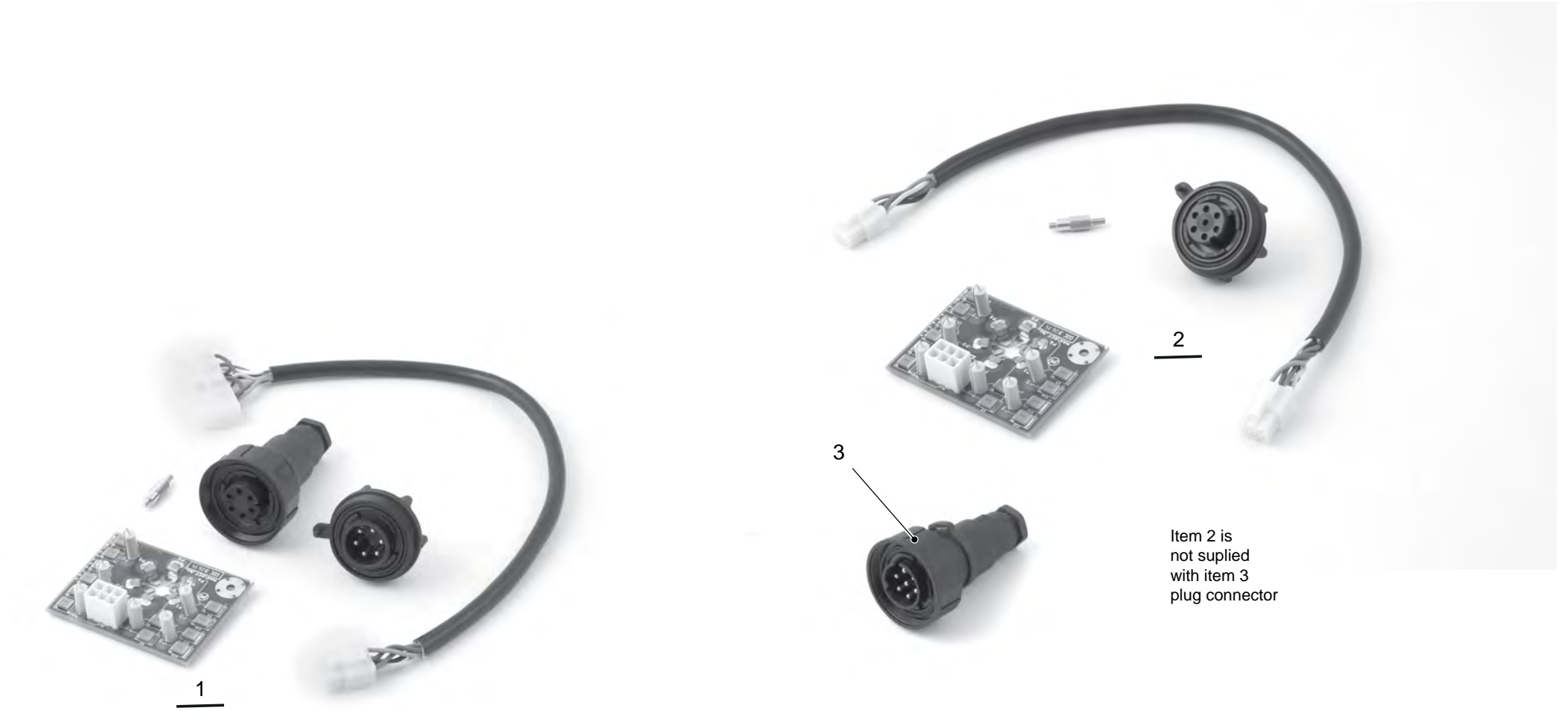

Item	Part Num	Description	Qty	Availability	Comments
1	FA67065	MULTI-STAGE ALARM (VFC) UPGRADE ASSY	1	EX-STOCK	Requires a Parallel I/O.
2	FA67064	MULTI-STAGE ALARM (24 V) UPGRADE ASSY	1	EX-STOCK	Requires a Parallel I/O.
3	FA67066	7 WAY IP67 BUCCANEER CABLE PLUG	1	EX-STOCK	Includes instructions.

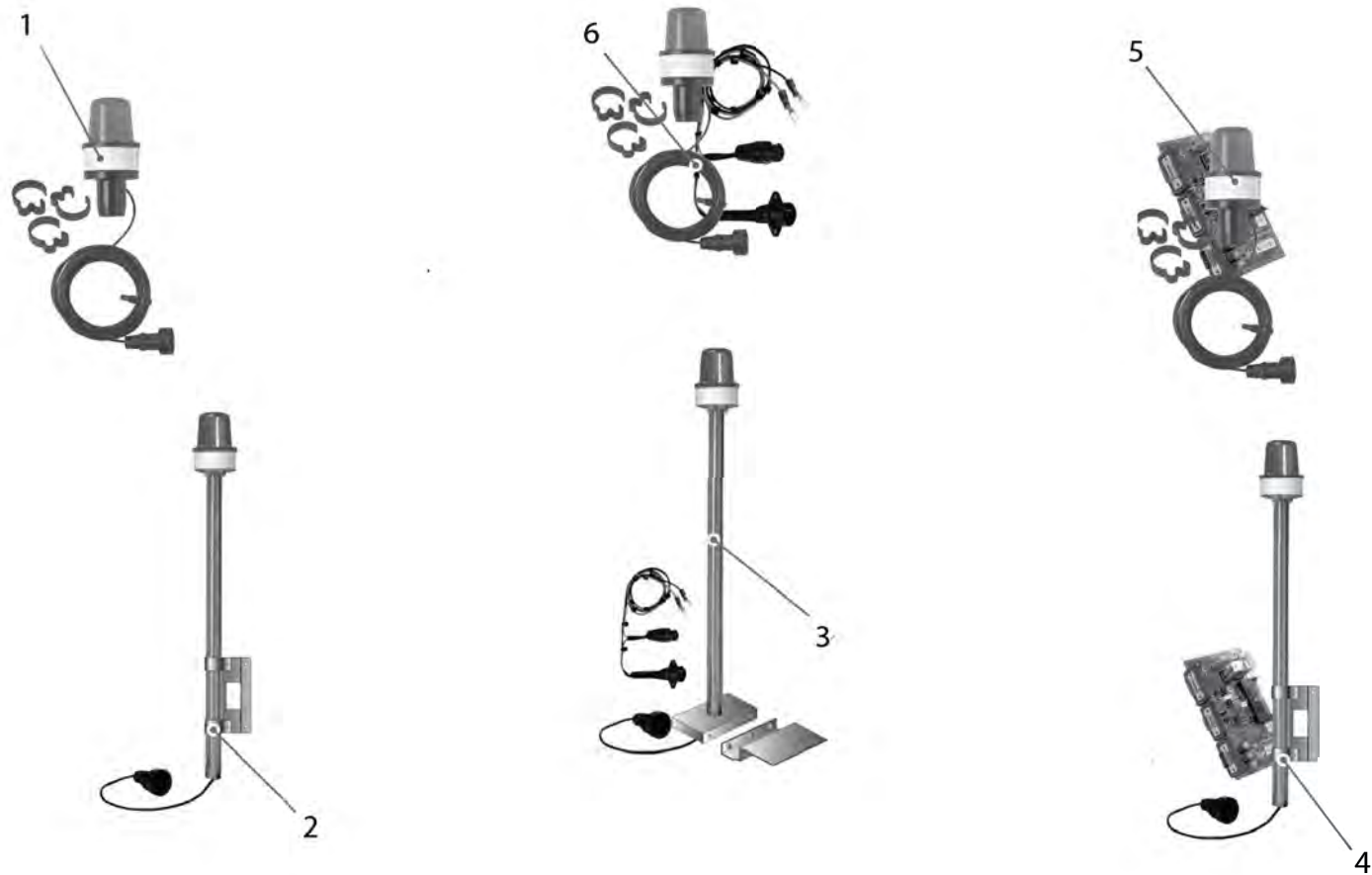

Item	Part Num	Description	Qty	Availability	Comments
1	FA64006	POLE MOUNT ALARM BEACON	1	EX-STOCK	A 24 V alarm beacon for use with a 32 mm pole. Includes three cable tidy clips.
2	FA61094	PRINTER MOUNT ALARM BEACON	1	EX-STOCK	For mounting a 24 V alarm beacon directly onto a printer.
3	FA61043	PRINTER MOUNT ALARM BEACON 6200	1	EX-STOCK	For mounting a 24 V alarm beacon directly onto a 6200 or 6000 printer.
4	FA61081	PRINTER MOUNT ALARM BEACON 4800	1	EX-STOCK	For mounting a 24 V alarm beacon directly onto a 4800 printer.

Linx Continuous Ink Jet Printers

Section 16 - Accessories - Beacons



Item	Part Num	Description	Qty	Availability	Comments
5	FA64007	POLE MOUNT ALARM BEACON 4800	1	EX-STOCK	24 V alarm beacon for 4800 printer. Needs 32mm pole. Includes 4800 Photocell PCB.
6	FA64008	POLE MOUNT ALARM BEACON 6200	1	EX-STOCK	A 24 V alarm beacon for use with a 32 mm pole. Includes tidy clips. For 6200.
	FA61099	REPLACEMENT RED 24-30 V ALARM BEACON	1	EX-STOCK	New style alarm beacon with adapter plate to replace old style 24 V alarm beacons.
	FA71083	ALARM LENS COVER	1	EX-STOCK	
	FA64012	AUDIO/VISUAL ALARM EXTERNAL BEACON 24 VDC	1	EX-STOCK	This alarm comes with parts to mount onto a printer.
	FA62059	CABLE TIDY	10	EX-STOCK	To secure cables to the outside of 32 mm diameter poles.

Linx Continuous Ink Jet Printers
Section 16 - Tools and Consumables - Customer Cleaning Kit

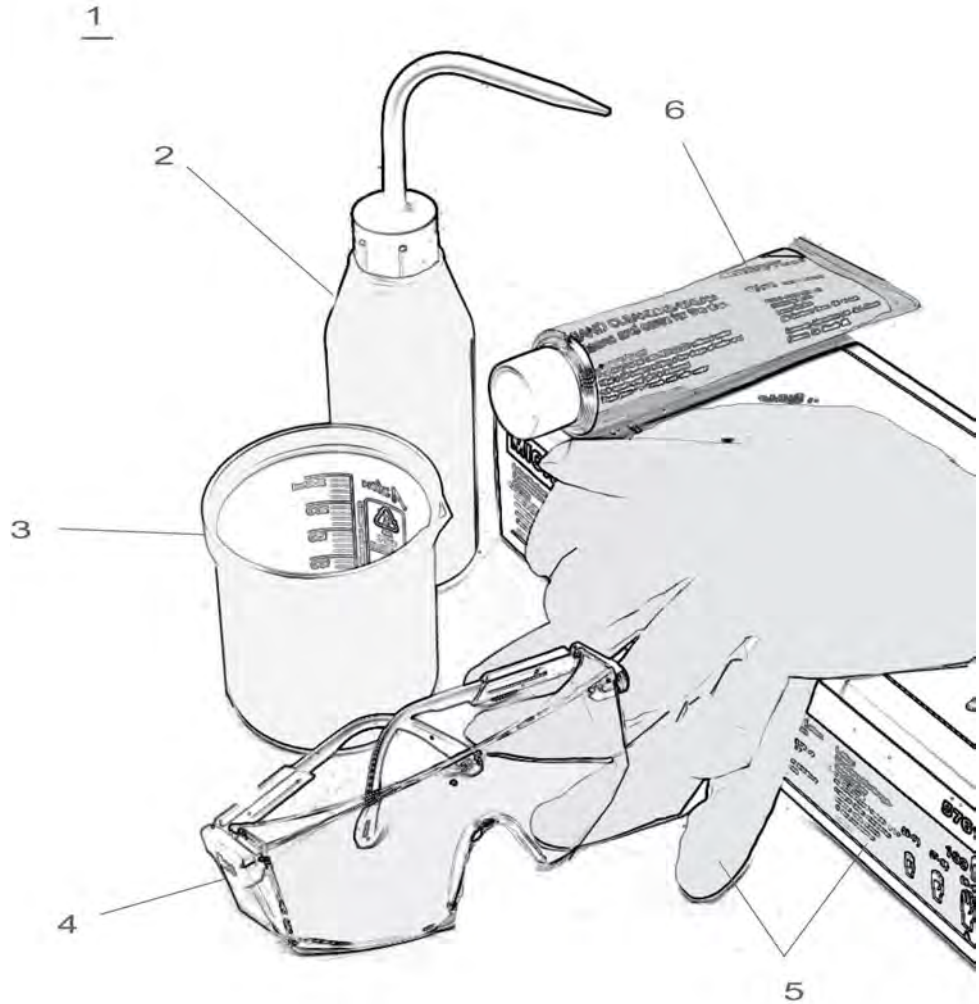

Item	Part Num	Description	Qty	Availability	Comments
1	FA60000	CUSTOMER CLEANING KIT	1	EX-STOCK	Contains solvent bottle,beaker,cleaner,gloves & safety spectacles.
2	FA900003	SOLVENT CLEANING BOTTLE	1	EX-STOCK	
3	FA900005	BEAKER 0.25 LITRE	1	EX-STOCK	
4	FA999076	SAFETY GLASSES	1	EX-STOCK	Not suitable for use as protection against laser damage.

Linx Continuous Ink Jet Printers

Section 16 - Tools and Consumables - Customer Cleaning Kit



Item	Part Num	Description	Qty	Availability	Comments
5	FA999058	GLOVE NITRILE LARGE 8-8.5	100	EX-STOCK	
6	FA999004	HAND CLEANER REINOLEN 150ML	1	EX-STOCK	
	FA69034	CLEANING SWAB PACK	100	EX-STOCK	
	FA69035	6800EC AND 6900FG CLEANING KIT	1	EX-STOCK	

Linx Continuous Ink Jet Printers

Section 16 - Tools and Consumables - Tools and Equipment



Item	Part Num	Description	Qty	Availability	Comments
	FA940042	ANTI-STATIC FIELD SERVICE ENGINEERS KIT	1	EX-STOCK	
	FA65019	SERVICE TECHNICIAN TOOL KIT (MIN)		Obsolete	
	FA65016	SCHEDULED MAINTENANCE TOOL KIT	1	EX-STOCK	Contains tools & equipment required to carry out scheduled maintenance.
	FA65018	SCHEDULED MAINTENANCE KIT (NON FILTERED DIP TUBES)	1	EX-STOCK	Includes Feed Damper assembly.
	FA74330	7900 SCHEDULED SERVICE KIT	1	EX-STOCK	For 7900 IP55,IP65 & Solver printers.
	FA999058	GLOVE NITRILE LARGE 8-8.5	100	EX-STOCK	
	FA65026	BASIC SCHEDULED MAINTENANCE KIT	1	EX-STOCK	For use with 4200CE,4800,4900,5900,6800,6900 & some 7900 printers.
	FA65027	SCHEDULED MAINTENANCE KIT	1	EX-STOCK	For 4200CE/4800/4900/5900/6800/6900,& some 7900 printers. Includes Feed Damper assembly.
	FA65032	BASIC SCHEDULED MAINTENANCE KIT (6200)	1	EX-STOCK	To support the 6200 printers with filtered dip tubes (refer to Service Bulletin SB441).
	FA65033	SCHEDULED MAINTENANCE KIT (6200)	1	EX-STOCK	To support the 6200 printers with filtered dip tubes (refer to Service Bulletin SB441).
	FA74331	SCHEDULED MAINTENANCE KIT - SPECTRUM	1	EX-STOCK	Inc. Filters: Air; Main Ink; Printhead; 3-way connector. Also Feed Damper.
	FA999076	SAFETY GLASSES	1	EX-STOCK	Not suitable for use as protection against laser damage.
	FA999075	OVERSPECS	1	EX-STOCK	To wear over normal spectacles. Not suitable for use as protection against laser damage.
	FA900004	BEAKER 0.1 LITRE	1	EX-STOCK	
	FA900005	BEAKER 0.25 LITRE	1	EX-STOCK	
	FA940024	D CONN FITTING TOOL		Obsolete	
	FA74077	9 WAY D-TYPE CONN FEMALE & SHELL - PACK	10	EX-STOCK	
	FA74005	DAMPER DRAIN TUBE	1	EX-STOCK	Used to drain the ink system.
	FA160019	STOP COCK 2-WAY LUER	1	4 WEEKS	Use with Damper Drain Tube FA74005.
	FA900006	FUNNEL 90MM DIAMETER	1	EX-STOCK	
	FA900003	SOLVENT CLEANING BOTTLE	1	EX-STOCK	
	FA940029	SOLVENT RESISTANT CLEANING BRUSH	1	EX-STOCK	
	FA940053	GENERAL PURPOSE CLEANING BRUSH 9MM DIAMETER	1	EX-STOCK	
	FA72151	EC NOZZLE ALIGNMENT TOOL	1	EX-STOCK	
	FA72116	NOZZLE ALIGNMENT TOOL	1	EX-STOCK	Suitable for all printheads except Mk1 & EC.
	FA74046	NOZZLE CLEANING SERVICE ACCESSORY	1	EX-STOCK	Refer to Manual for the Nozzle Cleaning Procedure.
	FA940003	EYEGLASS X9 MAGNIFICATION	1	EX-STOCK	
	FA940021	SYRINGE POLYPROPYLENE 50ML	1	EX-STOCK	
	FA940052	TUBE CUTTER PLASTIC 4-14 MM	1	EX-STOCK	
	FA940038	GATE ARRAY EXTRACTOR TOOL	1	EX-STOCK	
	FA999058	GLOVE NITRILE LARGE 8-8.5	100	EX-STOCK	

Linx Continuous Ink Jet Printers

Section 16 - Tools and Consumables - Tools and Equipment



Item	Part Num	Description	Qty	Availability	Comments
	FA65339	MANDREL EXTRACTION TOOL	1	EX-STOCK	
	FA65337	4800/6800 DIP TUBE REMOVAL TOOL	1	EX-STOCK	To ease the removal of the new ink & solvent dip tubes.
	FA65023	PRE-PUMP SWAGE TOOL	1	EX-STOCK	Used to open pre-pump (BP320003) filter inlet to accept metal insert (MP10020).
	FA20133	FLUID CONNECTOR 3-WAY - BLANKING PLATE	1	EX-STOCK	Stops flow through fluid lines when changing printheads.
	FA65107	FLUID CONNECTOR 3-WAY - GUTTER CLEAR	1	EX-STOCK	Connects feed line from ink system to gutter line on printhead.
	FA65108	FLUID CONNECTOR 3-WAY - PURGE TEST	1	EX-STOCK	Blanks off purge line from printhead side & from ink system side.
	FA65109	FLUID CONNECTOR 3-WAY - GUTTER TEST	1	EX-STOCK	Blanks off purge line from printhead side only.
	FA65022	FLUID CONNECTOR 3-WAY - SERVICE ACCESSORIES	1	EX-STOCK	Contains 1 each off FA20133,FA65107,FA65109 & a pack of filters (FA74163).
	FA10680	FLUID CONN 3-WAY - BLANK MALE - PIGMENTED	1	EX-STOCK	Stops flow through fluid lines when changing printheads.
	FA10517	FLUID CONN 3-WAY - GUTTER CLEAR - PIGMENTED	1	EX-STOCK	Connects feed line from ink system to gutter line on printhead.
	FA10520	FLUID CONN 3-WAY - PURGE TEST - PIGMENTED	1	EX-STOCK	Blanks off purge line from printhead side & from ink system side.
	FA10523	FLUID CONN 3-WAY - GUTTER TEST - PIGMENTED	1	EX-STOCK	Blanks off purge line from printhead side only.
	FA72150	FLUID CONN 3-WAY - SERVICE ACCESS- PIGMENTED	1	EX-STOCK	Contains 1 off FA10680,FA10517,FA10520,FA10523 plus a pack of filters (FA74189).
	FA16005	COVER REMOVAL TOOL	1	EX-STOCK	To operate the 4900,5900,6900,7300 & 7900 printer cover securing latch.
	FA65318	6800 COVER REMOVAL TOOL	1	EX-STOCK	To operate the 6800 cover securing latch.
	FA67059	REBOOT KIT	1	EX-STOCK	Use when rebooting software. Includes PROMs & cable. Not for 7900 software 5.2 and higher.
	FA75039	6800(SP) SYSTEM SOFTWARE CD		Obsolete	This software is now held on www.extralinx.com .
	FA75038	BOOT PROM SET	1	EX-STOCK	Boot PROM for 6800(SP),6900,7300. Also for 7900 printer below release 5.2
	FA67057	6800(DP) RE-BOOT KIT	1	EX-STOCK	Tool for use when rebooting software. Includes PROMs & cable.
	FA75023	6800(DP) SYSTEM SOFTWARE CD		Obsolete	This software is now held on www.extralinx.com .
	FA940067	DOUBLE-ENDED TRIM TOOL	1	EX-STOCK	
	FA999139	LINT-FREE ABSORBENT WIPES	1	EX-STOCK	

Linx Continuous Ink Jet Printers

Section 16 - Tools and Consumables - Consumables



Item	Part Num	Description	Qty	Availability	Comments
	FA999056	GLOVE NITRILE SMALL 6-6.5	100	EX-STOCK	
	FA999057	GLOVE NITRILE MEDIUM 7-7.5	100	EX-STOCK	
	FA999058	GLOVE NITRILE LARGE 8-8.5	100	EX-STOCK	
	FA999004	HAND CLEANER REINOLEN 150ML	1	EX-STOCK	
	FA999058	GLOVE NITRILE LARGE 8-8.5	100	EX-STOCK	
	FA999026	HAND CLEANER SLIG 250ML	1	EX-STOCK	
	FA399005	PTFE TAPE 12MM WIDE ROLL	1	EX-STOCK	
	FA399015	SHIELDING FOIL TAPE		Obsolete	
	FA74021	TIE WRAP BASE LRG 25SQ NYLON - PACK		Obsolete	
	FA74078	TIE WRAP BASE SMALL NYLON - PACK	100	EX-STOCK	
	FA74022	TIE WRAP EXTRA LARGE - PACK		Obsolete	
	FA77035	TIE WRAP LARGE & SMALL - PACK	100	EX-STOCK	